

From this
Moment on



Photo Credit: Dmitry Shumaney

Fairmont
GRAND DEL MAR

Your happily

Ever After

The Fairmont Grand Del Mar is far beyond a stay, but rather a blank canvas for designing a truly memorable experience.

Whether you are planning a grand wedding or an intimate event, Fairmont Grand Del Mar will meet every detail with meticulous attention and seamless ease.

Unparalleled quality allows for unexpected delights that transcend the traditional wedding venue experience.

It's your special day: *Make it Grand.*





Arrive at your
Destination

Located on 400 acres of coastal canyon, the Fairmont Grand Del Mar is an unparalleled sensory journey. With lush surroundings and tranquil spaces, this oasis of an estate is the perfect backdrop for your celebration.

Our inspired design and iconic venues offer exemplary settings in which to exchange vows, from gracious ballrooms to private venues.

Event Particulars

WEDDING PLANNER

It is required that you hire an approved professional wedding planner from our vendor list to attend to your special day, including all personalized details, photography, flowers, customized place settings, musical entertainment, transportation and orchestrating your rehearsal, ceremony and reception.

Your Fairmont Wedding Specialist assists in planning the resort details and serves as your liaison in finalizing the venue setup, food and beverage selections and guestroom accommodations.

CEREMONY LOCATIONS

Aria Lawn
seating up to 600 guests

Capella
seating up to 270 guests

Reflection Courtyard
seating 50 to 170 guests

RECEPTION FOOD & BEVERAGE

All food and beverage, including wine, must be provided exclusively through Fairmont Grand Del Mar. Evening events start at \$325 per person. Excludes service charge, CA state tax, decorations, and entertainment.

CEREMONY DETAILS

A ceremony fee reserves your location and includes the following:

- Wedding night accommodations for the bride and groom
- Bridal party changing room and groomsmen finishing room
- Fruit-infused water service
- Fully integrated sound system with wireless microphone and AV technician
- Ceremony chairs on the Aria Lawn or Reflection Courtyard and custom wooden pews for Capella
- Setup and breakdown of event space

PRICING, SALES TAX & SERVICE CHARGE

All prices are subject to change without notice and are excluding of a current 26% Service Charge and State Sales Tax, unless otherwise noted.

RECEPTION VENUES

Grand Ballroom
170-550 guests

Manchester Salon And Terrace
50-120 guests

Capella
120-170 guests

ENTRÉE SELECTIONS

In the event that your group requires multiple plated entrées, the entrée with the highest price will apply to all entrées. The hotel requires that the choices are limited to (2) entrées with an additional vegetarian option.

The hotel requires that the client produce place cards identifying the particular entrée selected by the guest and to be placed at each guest setting. If the hotel needs to produce more than the initial amount guaranteed for a specific entrée, the client is responsible for paying for those additional entrées.

DECOR

Fairmont Grand Del Mar offers floor-length gold cloths | Ecu overlays with matching napkins | The finest Hepp silverware | Villeroy & Boch china, and Schott-Zwiesel glassware.

PARKING & VALET

Event only valet parking is available at \$25 per car on your wedding day, charged to your master account or each guest.

DEPOSIT

A signed contract with an initial deposit of 25% of the estimated food and beverage costs and room rental is required to secure the space. Additional deposits and full settlement are due prior to the event.

Our wedding specialists would be delighted to curate a personalized estimate for your wedding.

Awe-Inspiring Venues



Photo Credit: Dmitry Shumanev

GRAND BALLROOM

MANCHESTER SALON & TERRACE

CAPELLA

ARIA LAWN

REFLECTION COURTYARD

WINE ROOMS



GRAND BALLROOM

This 10,000-square-foot setting offers, a built-in stage, ceiling heights from 18 to 19 feet, spacious wrap-around indoor and outdoor foyers, warm woods, imported stone, and rich color accents.

[LEARN MORE >](#)



MANCHESTER SALON & TERRACE

Detailed woodwork, hand-stenciled ceilings, chandeliers, and large arched windows. Manchester Terrace has garden and golf course views. Though the room is large, with 2,300 square feet of inviting space, it feels intimate and private.

[LEARN MORE >](#)



CAPELLA

With the antique timbered ceiling and leaded windows, this one-of-a-kind space spells sanctuary. Accents such as ornate chandeliers, polished marble, dark woods, imported stone, and stained glass create an artful, exotic ambiance.

[LEARN MORE >](#)

VENUES

Photo Credit: Dmitry Shumaney



ARIA LAWN

Your wedding will be accentuated by a dramatic pavilion and views of the resort's golf course and canyon preserve beneath the warm Southern California sun.

[LEARN MORE >](#)



REFLECTION COURTYARD

Surrounded by green hills, manicured gardens, and our serene reflection pool animated with arcing fountains, the outdoor space spans 2,500 square feet, with ample room for conversation and connection in and around the pool and gazebo.

[LEARN MORE >](#)



WINE ROOMS

Three richly-toned and expertly crafted wine rooms — Bordeaux, Burgundy, and Champagne — offer a combined 1,925 square feet. With encased wine bottles, wood-beamed ceilings, brick accents, and a sophisticated ambiance, these unique spaces are perfect for an extravagant and intimate wedding.

[LEARN MORE >](#)



Photo Credit: John & Joseph

Spaces and Capacities

Wine Rooms are located on First Floor. All other rooms are Third Floor/Lobby Level.

Room	DIMENSIONS / AREA		Ceremony	CAPACITIES			
	Feet	Sq. Ft.		Cocktail Reception	Heavy Reception	Banquet	Banquet + Dancefloor
Capella							
Capella (Chapel)	48' x 64'	3,072	270	400	240	240	170
Grand Ballrooms							
Ballroom A+B+C	126' x 77'	9,702	–	1,360	700	700	550
Ballroom B	60' x 72'	4,320	–	600	360	360	200
Ballroom A+B	75' x 92'	6,900	–	950	540	540	300
Ballroom B+C	75' x 92'	6,900	–	950	540	540	300
Manchester Salon & Terrace							
Manchester Salon	40' x 56'	2,240	–	250	150	150	120
Manchester Terrace	25' x 77'	1,925	–	120	110	110	–
Wine Rooms							
Combined	–	1,850	60	160	110	110	70
Outdoor							
Aria Lawn	60' x 136'	8,160	600	1,200	500	500	–
Reflection Courtyard	33' x 33'	1,080	300	300	300	80	–
Grand Social	115'x137'	23,000	–	600	500	500	–
Canyon Terrace	90'x114'	3,650	–	250	100	100	–

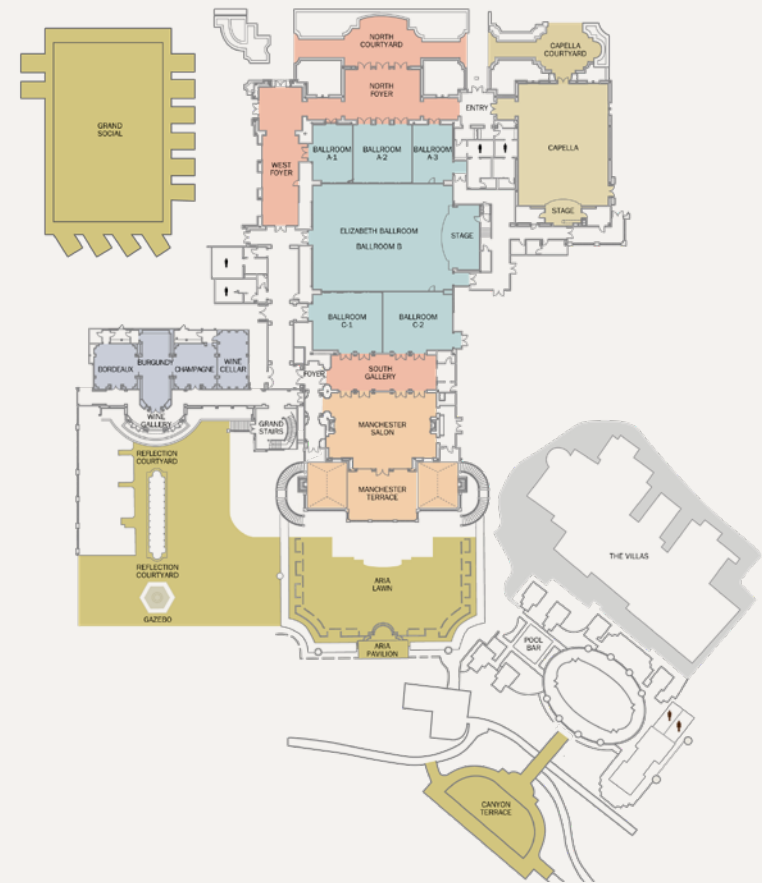



Photo Credit: Dmitry Shumaney

Fairmont

GRAND DEL MAR



Photo Credit: Jana Williams

To begin planning your special day, contact our Wedding Specialist at (858) 314-2010.



5300 Grand Del Mar Court | San Diego, California | United States 92130
T +1 858 314 2000 | F +1 858 314 2001 | granddelmar@fairmont.com
fairmont.com/san-diego